

1" DRIVE SOCKETS & ATTACHMENTS

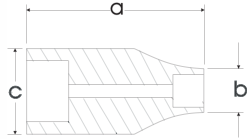

8 Point Standard Length Double Square Impact - Black Industrial Finish

| Hex Size | 8 Point Part No. | Overall Length in. a | Drive End in. b | Hex End in. c |
|----------|------------------|----------------------|-----------------|---------------|
| 1 5/8" | 7-652S | 2.99 | 2.28 | 3.07 |
| 1 11/16" | 7-654S | 3.07 | 2.44 | 3.31 |
| 1 3/4" | 7-656S | 3.07 | 2.44 | 3.31 |
| 1 13/16" | 7-658S | 3.15 | 2.44 | 3.39 |
| 1 7/8" | 7-660S | 3.35 | 2.44 | 3.46 |
| 2" | 7-664S | 3.35 | 2.44 | 3.62 |

Lock Ring and Pin

| Part No. | Description | |
|----------|--------------|-------------------|
| PLR100 | Locking Ring | .210 x 2.150" O/D |
| PLP100 | Locking Pin | .185 x 1.90" long |

Federal Spec. U.S. GGG-W-660 ANSI Spec. B1072-1975



XH25 24 Piece 12 Point Standard SAE Socket Set

Contains: 1 7/16", 1 1/2", 1 5/8", 1 11/16", 1 13/16", 1 7/8", 2", 2 3/16", 2 1/4", 2 5/16", 2 3/8", 2 7/16", 2 1/2", 2 9/16", 2 5/8", 2 3/4", 3"

Includes: 8" Extension, 17" Extension, Sliding "T" Handle, Reversible Ratchet, Flex Handle, Adapter 3/4" female 1" male, Metal Box # 9104